

GENERAL NOTES

1. ALL ELECTRICAL WORKS SHALL COMPLY IN ACCORDANCE WITH THIS PLAN AND SPECIFICATIONS. THE APPLICABLE PROVISIONS OF THE LATEST EDITION OF THE PHILIPPINE ELECTRICAL CODE (PEC). THE RULES AND REGULATION OF THE LOCAL ENFORCING AUTHORITY AND THE REQUIREMENTS OF THE LOCAL POWER COMPANY. THE ELECTRICAL WORKS SHALL BE UNDER IMMEDIATE SUPERVISION OF A DULY REGISTERED ELECTRICAL ENGINEER.
2. THE ELECTRICAL SERVICE POWER IS 1–PHASE, 2–WIRE, 230 V AC, 60 Hz.
3. WIRING METHOD SHALL BE AS FOLLOWS :

a. FEEDERS AND RISERS — INTERMEDIATE METALLIC CONDUIT

b. LIGHTING, POWER RECEPTACLE — POLYVINYL CHLORIDE CONDUIT BRANCH CKT., & AUXILIARY SCH. 40
4. ALL WIRES SHALL BE COPPER AND THERMOPLASTIC INSULATED TYPE "THW" UNLESS OTHERWISE INDICATED IN THE PLAN. THE MINIMUM SIZE OF WIRE FOR POWER AND LIGHTING CIRCUIT HOMERUN SHALL BE 3.5mm² AND INSULATED FOR 600 VOLTS. SMALLEST RACEWAY SHALL BE 15mmø TRADE/NOMINAL SIZE.
5. ALL OUTLET BOXES SHALL BE GALVANIZED GAUGE NO. 16 DEEP TYPE WITH FACTORY KNOCKOUTS.
6. ALL MATERIALS TO BE USED SHALL BE BRAND NEW AND APPROVED TYPE FOR THE PARTICULAR LOCATION AND PURPOSE OF USAGE.
7. GROUNDING SYSTEM SHALL BE PROVIDED TO ALL LIGHTING AND POWER CIRCUIT AS PER PHILIPPINE ELECTRICAL CODE REQUIREMENT.
8. MOUNTING HEIGHT OF WIRING DEVICES SHALL BE AS FOLLOWS :

a. LIGHT SWITCH — 1.20 M ABOVE FINISH FLOOR

b. CONVENIENCE OUTLET — 0.30 M ABOVE FINISH FLOOR.

c. PANELBOARD — 1.80 M ABOVE FINISH FLOOR

LEGEND

SYMBOL	DESCRIPTION
	— CEILING LIGHT OUTLET
	— 2 x 40 WATTS FLUORESCENT LAMP
	— CEILING FAN OUTLET
	— ONE GANG DEVICE SWITCH
	— TWO GANG DEVICE SWITCH
	— THREE GANG DEVICE SWITCH
	— 1 x 40 WATTS FLUORESCENT LAMP
	— FAN CONTROL SWITCH
	— RACEWAY CONDUIT CONCEALED IN CEILING
	— RACEWAY CONDUIT CONCEALED UNDER FLOOR
	— PANELBOARD
	— DUPLEX CONVENIENCE OUTLET, GROUNDING TYPE 10 AMPS, 250 VOLT WITH MODERN PLATE COVER
	— WEATHERPROOF TYPE DUPLEX CONVENIENCE OUTLET, GROUNDING TYPE 10 AMPS, 250 VOLT WITH MODERN PLATE COVER
	— HOMERUN DIRECT TO PANELBOARD
	— ELECTRIC SERVICE METER
	— SERVICE ENTRANCE

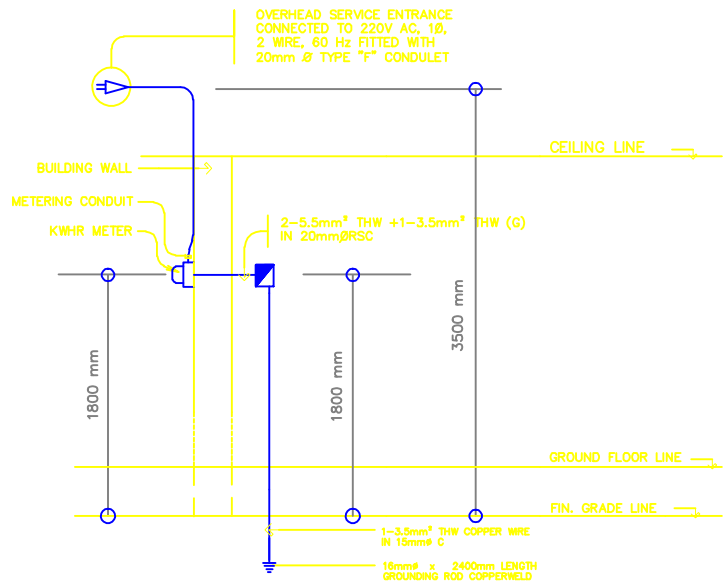

ELECTRICAL RISER DIAGRAM

NOT TO SCALE

LOAD SCHEDULE

PANELBOARD: LP								MAIN : 30AT, 50AF, 2P, 240V	
CKT. NO.	DESCRIPTION	VA LOAD	CIRCUIT BREAKER				WIRE & CONDUIT SIZE		
			VOLT	POLE	AT	AF			
1	CONVENIENCE OUTLET	720	230	2	20	50	3–3.5mm² THW IN 15mmø C		
2	LIGHTS & FAN	1200	230	2	20	50	3–3.5mm² THW IN 15mmø C		
3	SPARE	1500	230	2	20	50			
	TOTAL	3420							
<div>IL = <math>\frac{3420}{230\text{ V}}</math> = 15 A</div> <div>FEEDER: 2–5.5mm² THW + 1–3.5mm² THW(G) IN 20mm RSC</div> <div>PROTECTION: 30 AT, 50 AF, 2P, 240 V</div>									

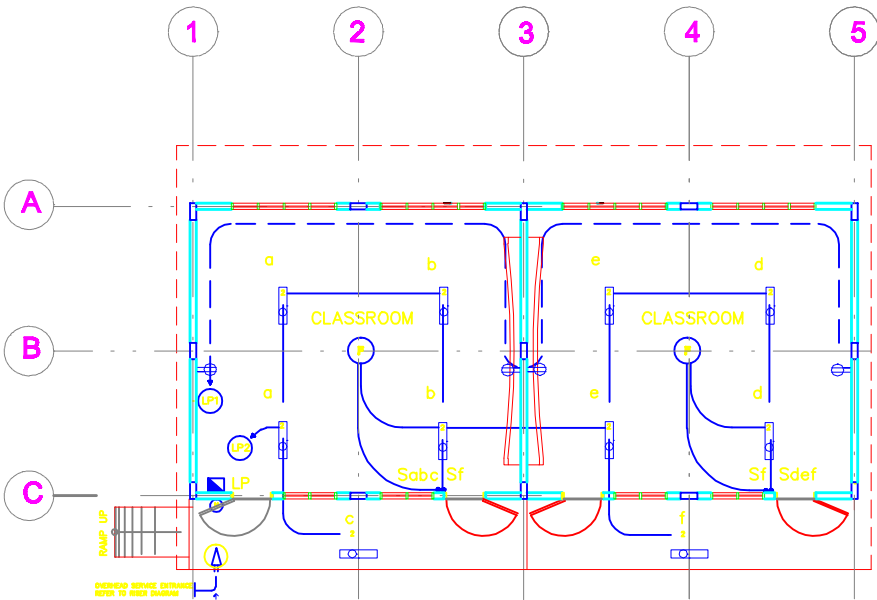

ELECTRICAL LAYOUT

SCALE 1:100 M

 REPUBLIC OF THE PHILIPPINES <b>DepED</b> DEPARTMENT OF EDUCATION PHYSICAL FACILITIES AND SCHOOLS ENGINEERING DIVISION MIRALDO AVENUE, DAVAO CITY	DESIGNED BY :	CHECKED BY :	RECOMMENDING APPROVAL :	APPROVED BY :	PROJECT TITLE :	PROJECT NO: PROJECT_NO	OWNER :	SHEET NO:
	 MAXIMO M. CALBANG DESIGNER_1 DESIGNER_2	 VENERANDO D. SAHAGUN ENGINEER III PFSED–DepED	 LUIS G. PURISIMA JR. HEAD, PLANNING & DESIGN UNIT PFSED–DepED	 OLIVER R. HERNANDEZ CHIEF, PFSED–OPS DepED	ONE STOREY TWO-CLASSROOM SCHOOLBUILDING (MOD.)	DESIGNED BY: DESIGNED_BY ENCODED BY: ENCODED_BY CHECKED BY: CHECKED_BY DATE: DATE	DEPARTMENT OF EDUCATION DepED SHEET CONTENTS : GENERAL NOTES & WINDOW LEGEND ELECTRICAL LAYOUT, RISER DIAGRAM LIGHTS, FAN, RAMP, ETC.	
					LOCATION :			

NOTE: THIS DRAWING, AS AN INSTRUMENT OF SERVICE IS THE PROPERTY OF TASK FORCE ENGINEERING, ASSESSMENT AND MONITORING AND NO SUCH MUST NOT BE REPRODUCED OR COPIED IN PART OR IN WHOLE WITHOUT THEIR PERMISSION. ALL DRAWINGS ARE TO BE RETURNED WHEN NO LONGER IN USE.