

GENERAL NOTES

- ALL ELECTRICAL WORKS SHALL COMPLY IN ACCORDANCE WITH THESE PLANS AND SPECIFICATIONS. THE APPLICABLE PROVISIONS OF THE LATEST EDITION OF THE PHILIPPINE ELECTRICAL CODE (PEC). THE RULES AND REGULATION OF THE LOCAL ENFORCING AUTHORITY AND THE REQUIREMENTS OF THE LOCAL POWER COMPANY. THE ELECTRICAL WORKS SHALL BE DONE UNDER THE IMMEDIATE SUPERVISION OF A DULY REGISTERED ELECTRICAL ENGINEER.
- THE ELECTRICAL SERVICE POWER IS 1-PHASE, 2-WIRE, 230 V AC, 60 Hz.
- WIRING METHOD SHALL BE AS FOLLOWS :
 - FEEDERS AND RISERS - INTERMEDIATE METALLIC CONDUIT
 - LIGHTING, POWER RECEPTACLE - POLYVINYL CHLORIDE CONDUIT SCH. 40 BRANCH CKT., & AUXILIARY
- ALL WIRES SHALL BE COPPER AND THERMOPLASTIC INSULATED TYPE "THW" UNLESS OTHERWISE INDICATED IN THE PLAN. THE MINIMUM SIZE OF WIRE FOR POWER AND LIGHTING CIRCUIT HOMERUN SHALL BE 3.5mm² AND INSULATED FOR 600 VOLTS. SMALLEST RACEWAY SHALL BE 15mmØ TRADE/NOMINAL SIZE. I
- ALL OUTLET BOXES SHALL BE GALVANIZED GAGE NO. 16 DEEP TYPE WITH FACTORY KNOCKOUTS.
- ALL MATERIALS TO BE USED SHALL BE BRAND NEW AND APPROVED TYPE FOR THE PARTICULAR LOCATION AND PURPOSE OF USAGE.
- GROUNDING SYSTEM SHALL BE PROVIDED TO ALL LIGHTING AND POWER CIRCUIT AS PER PHILIPPINE ELECTRICAL CODE REQUIREMENT.
- MOUNTING HEIGHT OF WIRING DEVICES SHALL BE AS FOLLOWS :
 - LIGHT SWITCH - 1.20 M ABOVE FINISH FLOOR
 - CONVENIENCE OUTLET - 0.30 M ABOVE FINISH FLOOR.
 - PANELBOARD - 1.50 M ABOVE FINISH FLOOR
 - FIRE ALARM STATION OUTLET - 1.50 M. ABOVE FINISH FLOOR
 - PUSH BUTTON OUTLET - 1.20 M ABOVE FINISH FLOOR
 - FIRE ALARM & VIBRATING BELL - 0.30 M BELOW CEILING LINE

LEGEND

SYMBOL	DESCRIPTION
	CEILING LIGHT OUTLET
	2 x 40 WATTS FLUORESCENT LAMP
	CEILING FAN OUTLET
S/S _a	ONE GANG DEVICE SWITCH
S _{ab}	TWO GANG DEVICE SWITCH
S _{cde}	THREE GANG DEVICE SWITCH
S _{3W}	THREE WAY DEVICE SWITCH
S _f	FAN CONTROL SWITCH
S _{EF}	EXHAUST FAN SWITCH
	RACEWAY CONDUIT CONCEALED IN CEILING
	RACEWAY CONDUIT CONCEALED UNDER FLOOR
	PANELBOARD
	CKT. BREAKER, RATING AS INDICATED
	DUPLEX CONVENIENCE OUTLET, GROUNDING TYPE 10 AMPS, 250 VOLT WITH MODERN PLATE COVER
	EXHAUST FAN OUTLET, SINGLE, GROUNDING TYPE 10 AMPS, 250 VOLT WITH MODERN PLATE COVER
	HOMERUN DIRECT TO PANELBOARD
	PUSH BUTTON
	ENCLOSED AIR CIRCUIT BREAKER
	FIRE ALARM CONTROL PANEL
	FIRE ALARM STATION OUTLET
	VIBRATING BELL OUTLET
	FIRE ALARM BELL
	SERVICE METER
	SERVICE ENTRANCE

LOAD SCHEDULE

PANELBOARD: LP							MAIN : 100AT, 100AF, 2P, 230V	
CKT. NO.	DESCRIPTION	VA LOAD	CIRCUIT BREAKER			WIRE & CONDUIT SIZE		
			VOLT	POLE	A T A F			
1	CONVENIENCE OUTLET - 9x180w	1860	230	2	20	50	3.35mm ² THW IN 15mmØ C	
2	CONVENIENCE OUTLET - 9x180w	1860	230	2	20	50	3.35mm ² THW IN 15mmØ C	
3	CONVENIENCE OUTLET - 6x180w	1080	230	2	20	50	3.35mm ² THW IN 15mmØ C	
4	LIGHTING OUTLET	1460	230	2	20	50	3.35mm ² THW IN 15mmØ C	
5	LIGHTING OUTLET	1500	230	2	20	50	3.35mm ² THW IN 15mmØ C	
6	LIGHTING OUTLET	1200	230	2	20	50	3.35mm ² THW IN 15mmØ C	
7	LIGHTING OUTLET	1000	230	2	20	50	3.35mm ² THW IN 15mmØ C	
8	LIGHTING OUTLET	1100	230	2	20	50	3.35mm ² THW IN 15mmØ C	
9	LIGHTING OUTLET	1100	230	2	20	50	3.35mm ² THW IN 15mmØ C	
10	S P A R E	1500	230	2	20	50		
11	S P A R E	1500	230	2	20	50		
TOTAL		14680						
IL @ 80% D.F. = 14680 x 80% = 11744 VA		x 1.25 = 14680 VA		= 63.8 A				
		230 V						
				FEEDER: 2-30mm ² THW IN 32mmØ C				
				PROTECTION: 150 AT, 225 AF, 2P, 230 V				

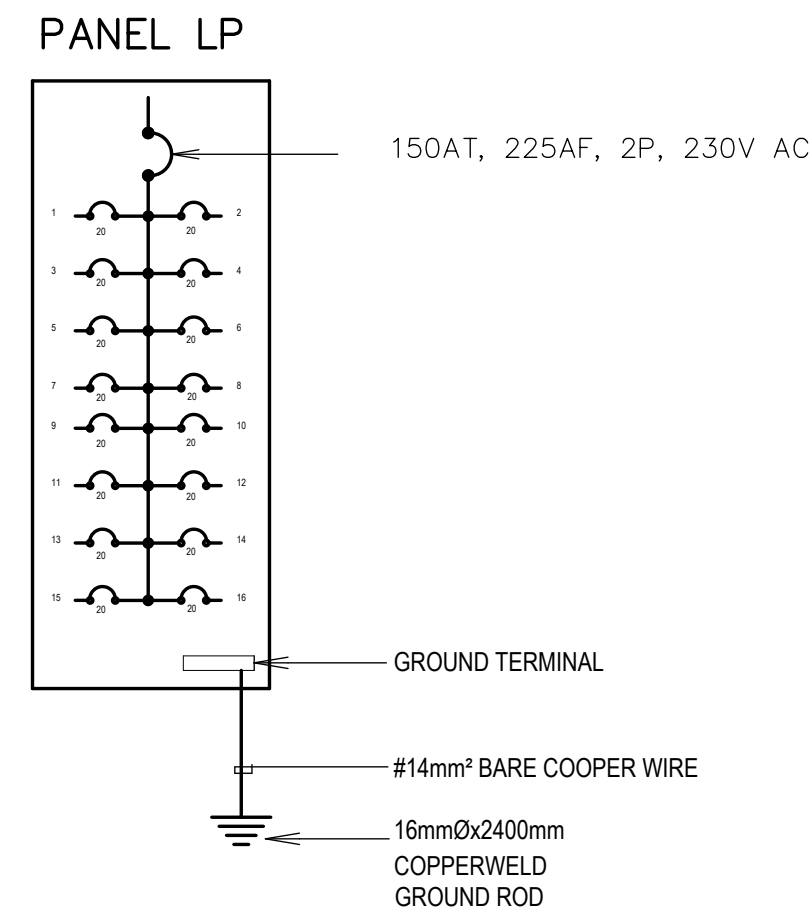

SINGLE LINE DIAGRAM

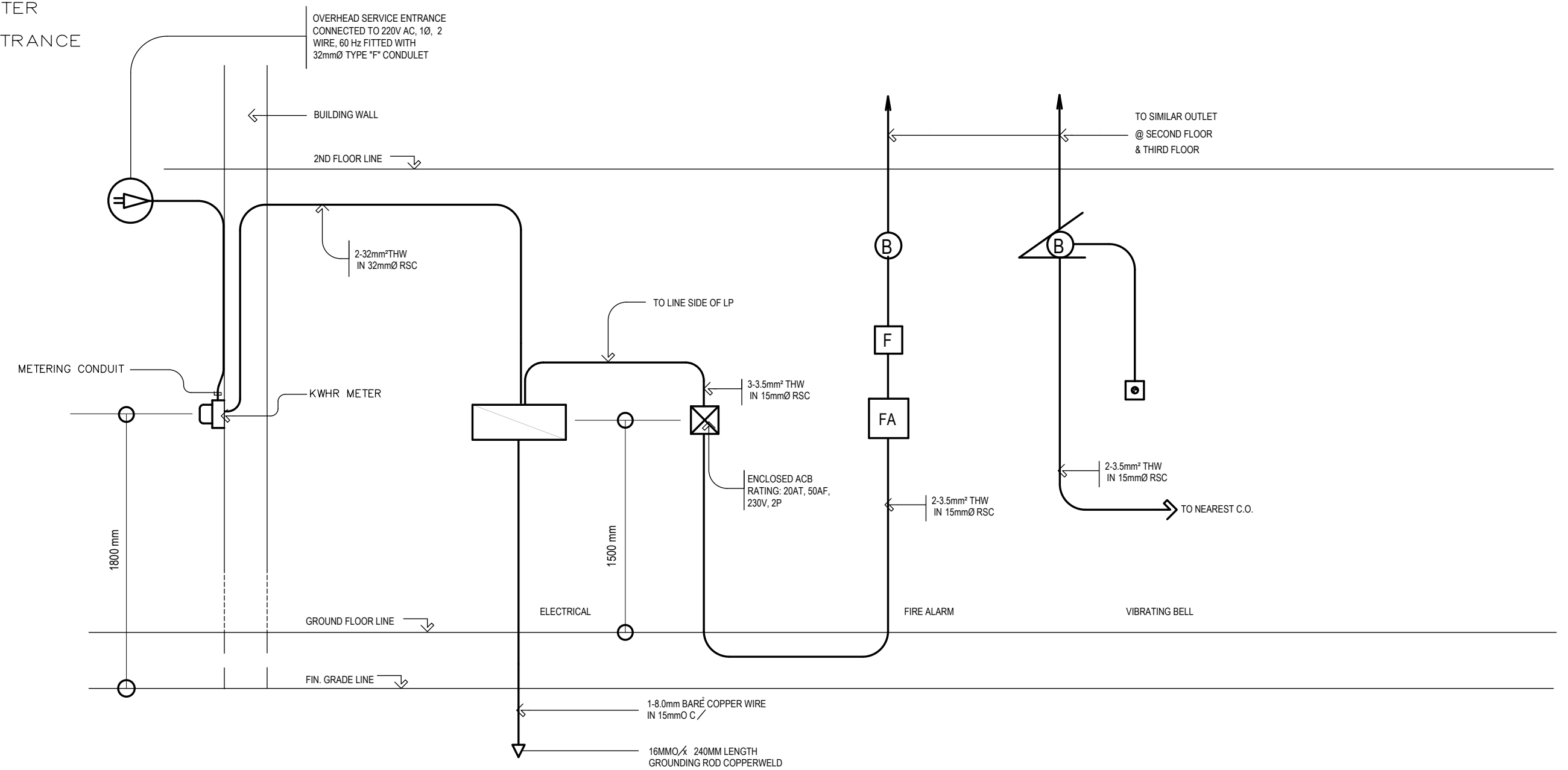

RISER DIAGRAM

<p>REPUBLIC OF THE PHILIPPINES DEPARTMENT OF EDUCATION (DepED) TASK FORCE ENGINEERING, ASSESSMENT AND MONITORING MERALCO AVENUE, PASIG CITY</p>	CONSULTANT / DESIGNER VENERANDO D. SAHAGUN ENGINEER III	REVIEWED BY: FE M. BARRIENTOS CHIEF, ELECTRICAL DIVISION BUREAU OF DESIGN, DPWH	RECOMMENDING APPROVAL : SOFIA T. SANTIAGO OIC, DIRECTOR III BUREAU OF DESIGN, DPWH	APPROVED FOR ACCREDITATION : GILBERTO S. REYES OIC, DIRECTOR IV BUREAU OF DESIGN, DPWH	CONCURRED : RAMON C. BACANI UNDERSECRETARY DEPARTMENT OF EDUCATION (DepED)	PROJECT TITLE : THREE STOREY SIX CLASSROOM W/MULTI-PURPOSE	PROJECT NO: 01-002 DESIGNED BY: RDS ENCODED BY: Max C CHECKED BY: DATE : 6-23-03	OWNER : DEPARTMENT OF EDUCATION DepED	SHEET NO: E-1 3
	PRC NO. : _____ TIN : _____ PTR NO. : _____ DATE : _____	SHEET CONTENTS : LOAD SCHEDULE GENERAL NOTES SINGLE LINE DIAGRAM RISER DIAGRAM		LOCATION :		DATE : 6-23-03			

THE REVIEW & APPROVAL OF THIS PLANS BY THE DPWH DOES NOT RELIEVE THE DESIGNER/CONSULTANT FROM RESPONSIBILITY FOR THE SAFETY OF THE COMPLETED FACILITIES AS WELL AS FOR THE FAILURE OF THE SAME DUE TO FAULTY DESIGN.

NOTE: THIS DRAWING, AS AN INSTRUMENT OF SERVICE IS THE PROPERTY OF TASK FORCE ENGINEERING, ASSESSMENT AND MONITORING AND AS SUCH MUST NOT BE REPRODUCED OR COPIED IN PART OR IN WHOLE WITHOUT THEIR PERMISSION. ALL DRAWINGS ARE TO BE RETURNED WHEN NO LONGER IN USE.

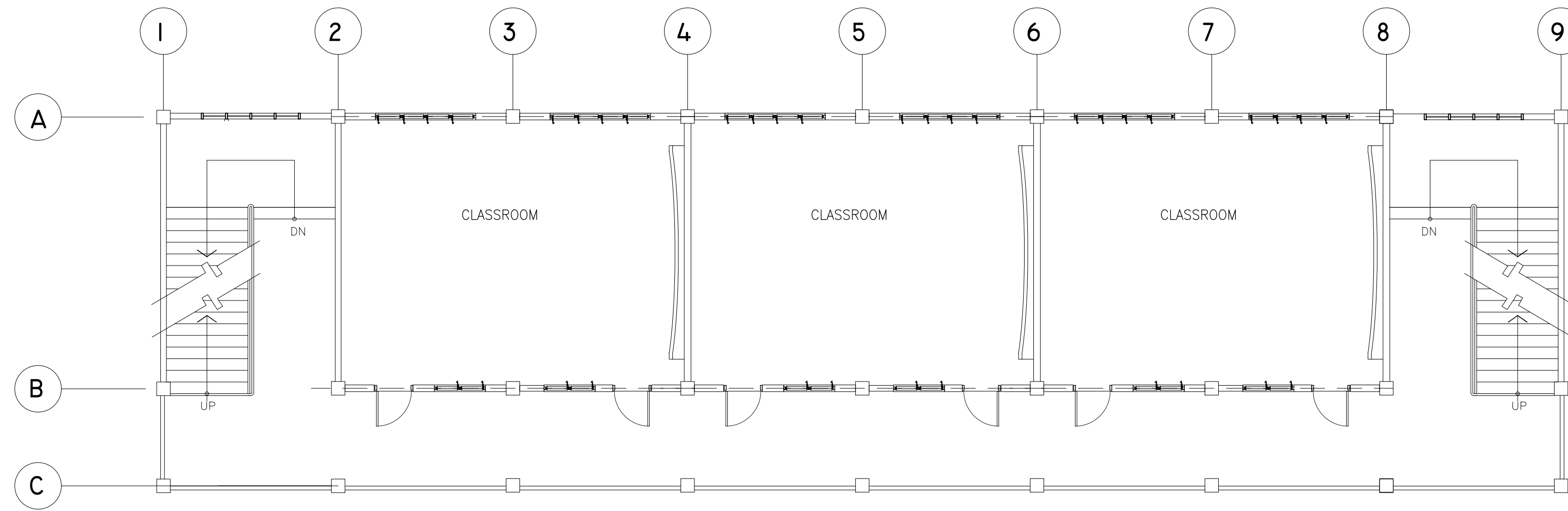

TYPICAL 2ND & 3RD FLOOR LIGHTING LAYOUT

SCALE : 1 : 100 METERS

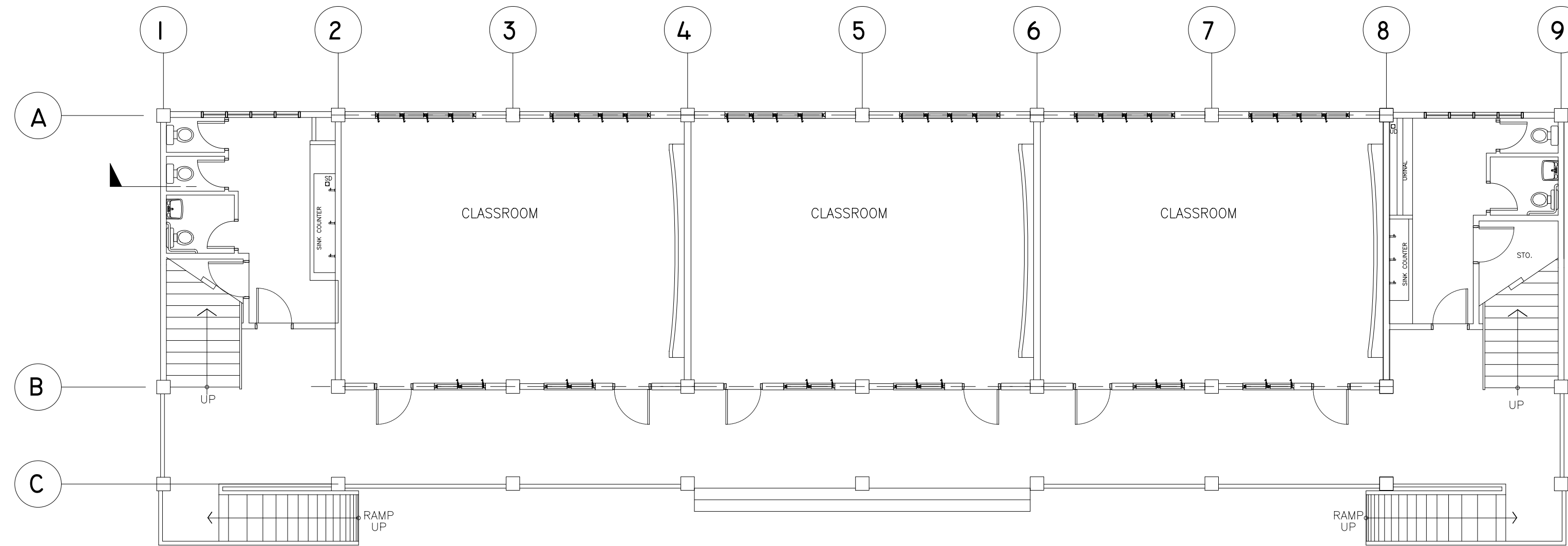

GROUND FLOOR LIGHTING LAYOUT

SCALE : 1 : 100 METERS

<p>REPUBLIC OF THE PHILIPPINES DEPARTMENT OF EDUCATION (DepED) TASK FORCE ENGINEERING, ASSESSMENT AND MONITORING MERALCO AVENUE, PASIG CITY</p>	<p>CONSULTANT / DESIGNER</p> <p>VINCENTO T. SAMPAGUN ELECTRICAL ENGINEER</p>	<p>REVIEWED BY:</p> <p>FE. M. BARRIENTOS CHIEF, ELECTRICAL DIVISION BUREAU OF DESIGN, DPWH</p>	<p>RECOMMENDING APPROVAL :</p> <p>SOFIA T. SANTIAGO OIC, DIRECTOR III BUREAU OF DESIGN, DPWH</p>	<p>APPROVED FOR ACCREDITATION :</p> <p>GILBERTO S. REYES OIC, DIRECTOR IV BUREAU OF DESIGN, DPWH</p>	<p>CONCURRED :</p> <p>RAMON C. BACANI UNDERSECRETARY DEPARTMENT OF EDUCATION (DepED)</p>	<p>PROJECT TITLE :</p> <p>THREE STOREY SIX CLASSROOM W/MULTI-PURPOSE</p>	<p>PROJECT NO: 01-002</p> <p>DESIGNED BY: RDS</p> <p>ENCODED BY: Max C</p> <p>CHECKED BY:</p> <p>DATE : 01 03</p>	<p>OWNER :</p> <p>DEPARTMENT OF EDUCATION DepED</p> <p>SHEET CONTENTS :</p> <p>LIGHTING LAYOUT</p>	<p>SHEET NO:</p> <p>E-2 3</p>	
	<p>PRC NO. : _____ TIN : _____</p> <p>PTR NO. : _____ DATE : _____</p>					<p>LOCATION :</p>				
	<p>NOTE: THIS DRAWING, AS AN INSTRUMENT OF SERVICE IS THE PROPERTY OF TASK FORCE ENGINEERING, ASSESSMENT AND MONITORING AND AS SUCH MUST NOT BE REPRODUCED OR COPIED IN PART OR IN WHOLE WITHOUT THEIR PERMISSION. ALL DRAWINGS ARE TO BE RETURNED WHEN NO LONGER IN USE.</p>									
	<p>THE REVIEW & APPROVAL OF THIS PLANS BY THE DPWH DOES NOT RELIEVE THE DESIGNER/CONSULTANT FROM RESPONSIBILITY FOR THE SAFETY OF THE COMPLETED FACILITIES AS WELL AS FOR THE FAILURE OF THE SAME DUE TO FAULTY DESIGN.</p>									

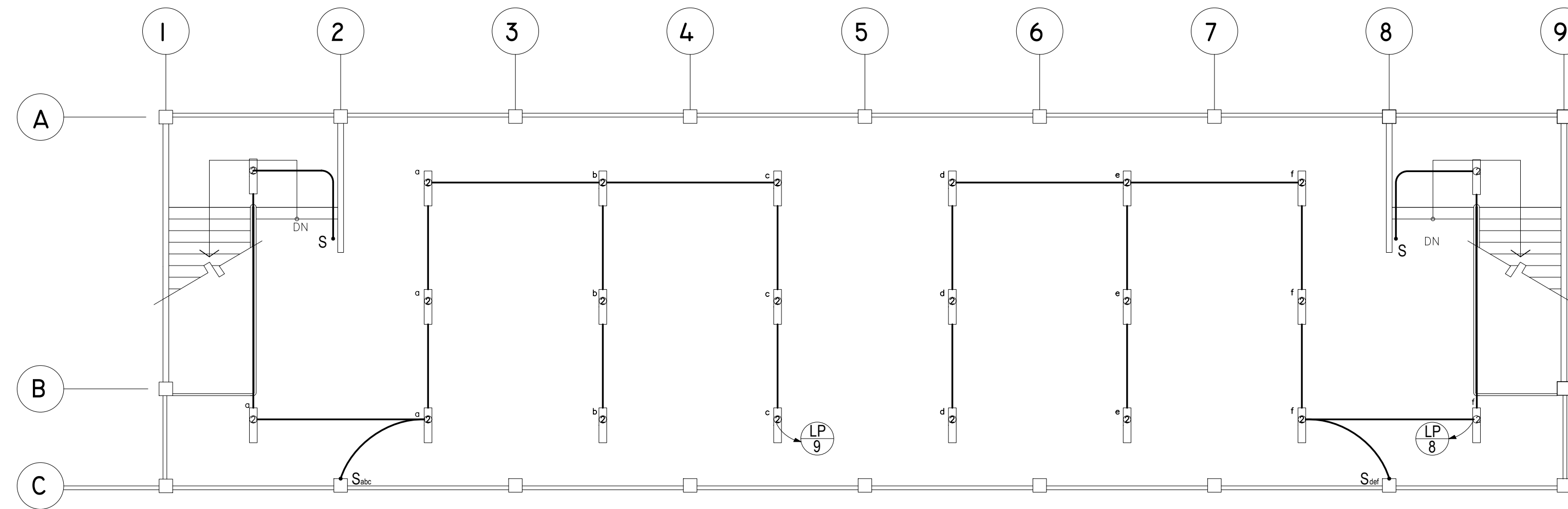

THIRD FLOOR LIGHTING LAYOUT

SCALE : 1 : 100 METERS

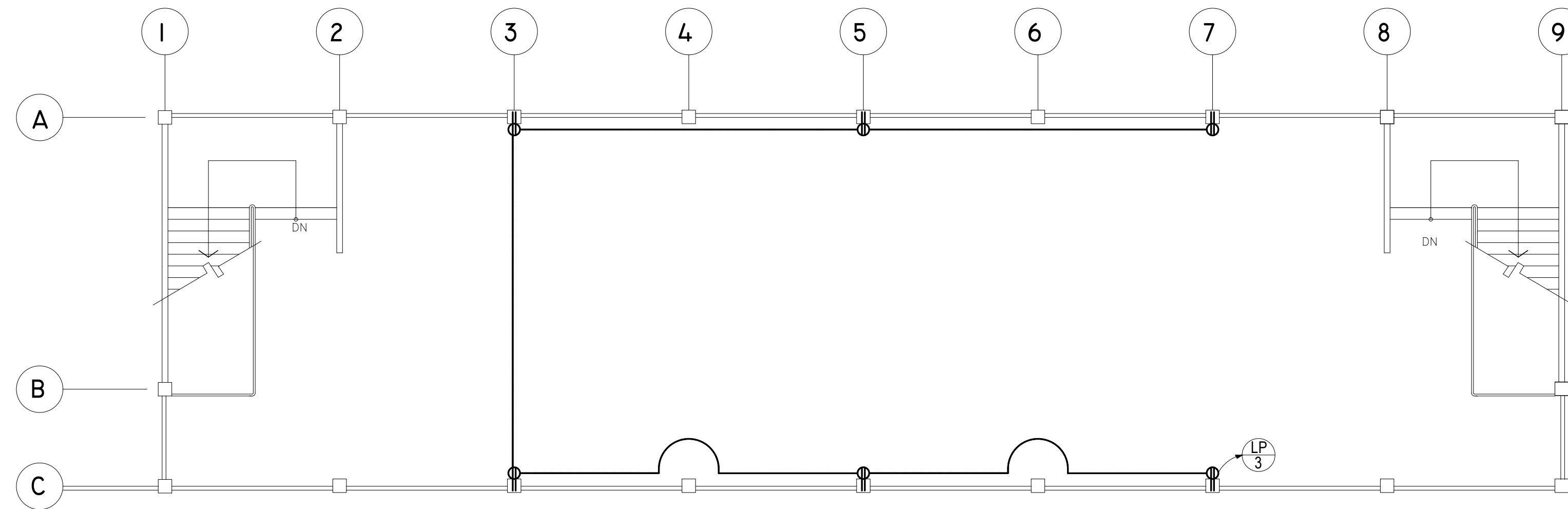

THIRD FLOOR POWER LAYOUT

SCALE : 1 : 100 METERS

<p>REPUBLIC OF THE PHILIPPINES DEPARTMENT OF EDUCATION (DepED) TASK FORCE ENGINEERING, ASSESSMENT AND MONITORING MERALCO AVENUE, PASIG CITY</p>	CONSULTANT / DESIGNER VENERANDO D. SAHAGUN <small>ENGINEER III</small>	REVIEWED BY: FE M. BARRIENTOS <small>CHIEF, ELECTRICAL DIVISION BUREAU OF DESIGN, DPWH</small>	RECOMMENDING APPROVAL : SOFIA T. SANTIAGO <small>OIC, DIRECTOR III BUREAU OF DESIGN, DPWH</small>	APPROVED FOR ACCREDITATION : GILBERTO S. REYES <small>OIC, DIRECTOR IV BUREAU OF DESIGN, DPWH</small>	CONCURRED : RAMON C. BACANI <small>UNDERSECRETARY DEPARTMENT OF EDUCATION (DepED)</small>	PROJECT TITLE : THREE STOREY SIX CLASSROOM W/MULTI-PURPOSE	PROJECT NO: 01-002 DESIGNED BY: RDS ENCODED BY: Max C CHECKED BY: DATE : 01 03	OWNER : DEPARTMENT OF EDUCATION DepED	SHEET NO: E-3 3
	PRC NO. : _____ TIN : _____ PTR NO. : _____ DATE : _____					LOCATION :	SHEET CONTENTS : POWER LAYOUT		
	<small>THE REVIEW & APPROVAL OF THIS PLANS BY THE DPWH DOES NOT RELIEVE THE DESIGNER/CONSULTANT FROM RESPONSIBILITY FOR THE SAFETY OF THE COMPLETED FACILITIES AS WELL AS FOR THE FAILURE OF THE SAME DUE TO FAULTY DESIGN.</small>							<small>NOTE: THIS DRAWING, AS AN INSTRUMENT OF SERVICE IS THE PROPERTY OF TASK FORCE ENGINEERING, ASSESSMENT AND MONITORING AND AS SUCH MUST NOT BE REPRODUCED OR COPIED IN PART OR IN WHOLE WITHOUT THEIR PERMISSION. ALL DRAWINGS ARE TO BE RETURNED WHEN NO LONGER IN USE.</small>	

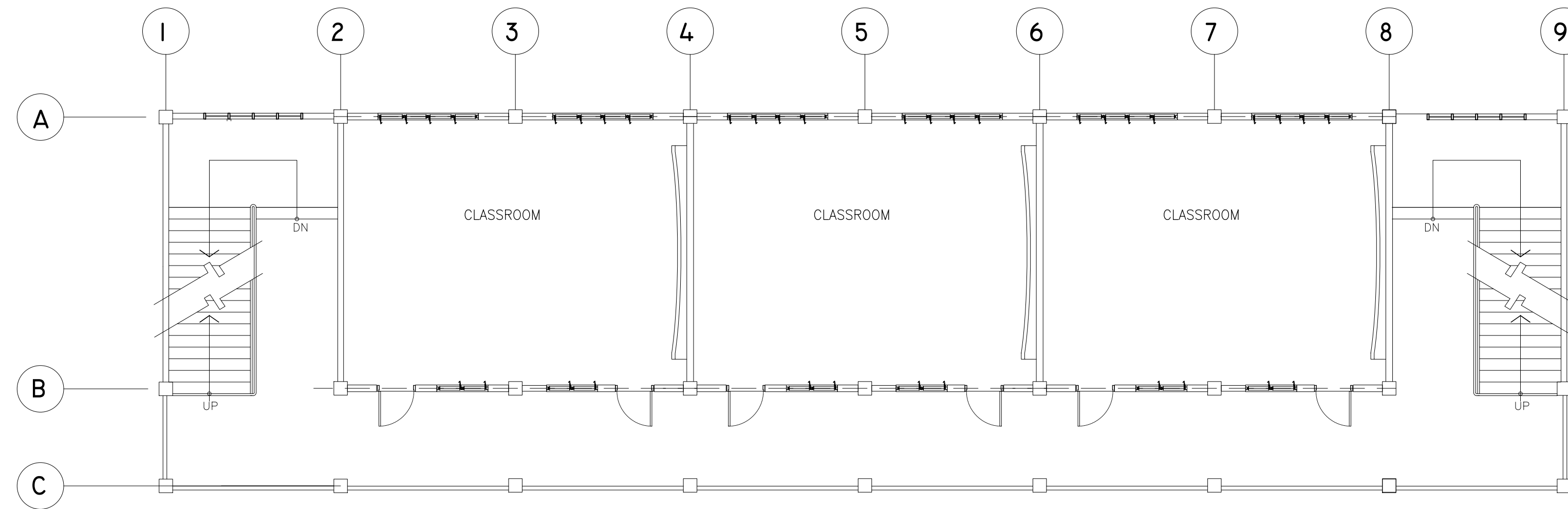

TYPICAL 2ND & 3RD FLOOR POWER LAYOUT

SCALE : 1 : 100 METERS

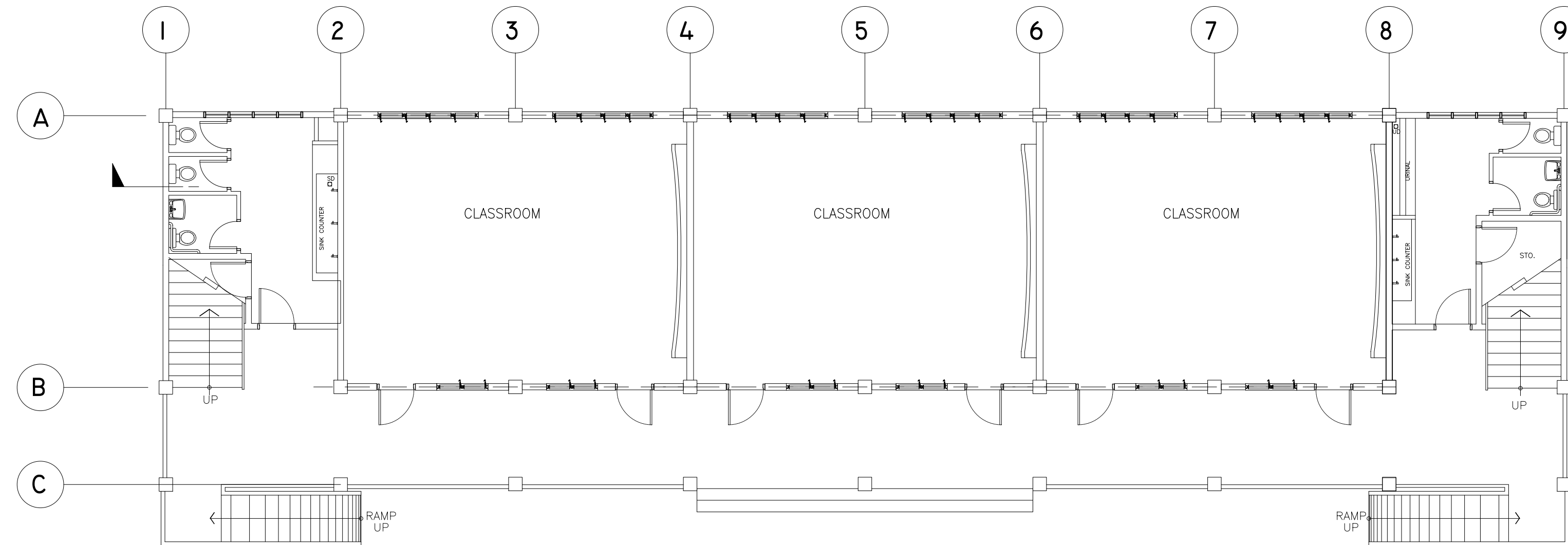

GROUND FLOOR POWER LAYOUT

SCALE : 1 : 100 METERS

<p>REPUBLIC OF THE PHILIPPINES DEPARTMENT OF EDUCATION (DepED) TASK FORCE ENGINEERING, ASSESSMENT AND MONITORING MERALCO AVENUE, PASIG CITY</p>	<p>CONSULTANT / DESIGNER</p> <p>VENERANDO S. BARRIENTOS ELECTRICAL ENGINEER</p>	<p>REVIEWED BY:</p> <p>FE M. BARRIENTOS CHIEF, ELECTRICAL DIVISION BUREAU OF DESIGN, DPWH</p>	<p>RECOMMENDING APPROVAL :</p> <p>SOFIA T. SANTIAGO OIC, DIRECTOR III BUREAU OF DESIGN, DPWH</p>	<p>APPROVED FOR ACCREDITATION :</p> <p>GILBERTO S. REYES OIC, DIRECTOR IV BUREAU OF DESIGN, DPWH</p>	<p>CONCURRED :</p> <p>RAMON C. BACANI UNDERSECRETARY DEPARTMENT OF EDUCATION (DepED)</p>	<p>PROJECT TITLE :</p> <p>THREE STOREY SIX CLASSROOM W/MULTI-PURPOSE</p>	<p>PROJECT NO: 001-0022</p> <p>DESIGNED BY: RDS</p> <p>ENCODED BY: MBS C</p> <p>CHECKED BY:</p> <p>DATE : 16-23-081 03</p>	<p>OWNER :</p> <p>DEPARTMENT OF EDUCATION DepED</p> <p>SHEET CONTENTS :</p> <p>POWER LAYOUT</p>	<p>SHEET NO:</p> <p>E-3 3</p>
	<p>PRC NO. : _____ TIN : _____</p> <p>PTR NO. : _____ DATE : _____</p>					<p>LOCATION :</p>			
	<p>NOTE: THIS DRAWING, AS AN INSTRUMENT OF SERVICE IS THE PROPERTY OF TASK FORCE ENGINEERING, ASSESSMENT AND MONITORING AND AS SUCH MUST NOT BE REPRODUCED OR COPIED IN PART OR IN WHOLE WITHOUT THEIR PERMISSION. ALL DRAWINGS ARE TO BE RETURNED WHEN NO LONGER IN USE.</p>								

THE REVIEW & APPROVAL OF THIS PLANS BY THE DPWH DOES NOT RELIEVE THE DESIGNER/CONSULTANT FROM RESPONSIBILITY FOR THE SAFETY OF THE COMPLETED FACILITIES AS WELL AS FOR THE FAILURE OF THE SAME DUE TO FAULTY DESIGN.