

GENERAL NOTES

- ALL ELECTRICAL WORKS SHALL COMPLY IN ACCORDANCE WITH THESE PLANS AND SPECIFICATIONS. THE APPLICABLE PROVISIONS OF THE LATEST EDITION OF THE PHILIPPINE ELECTRICAL CODE (PEC). THE RULES AND REGULATION OF THE LOCAL ENFORCING AUTHORITY AND THE REQUIREMENTS OF THE LOCAL POWER COMPANY. ALL ELECTRICAL WORKS SHALL BE UNDER THE IMMEDIATE SUPERVISION OF A DULY REGISTERED ELECTRICAL ENGINEER.
- THE ELECTRICAL SERVICE POWER IS 1-PHASE, 2-WIRE, 230 V AC, 60 Hz.
- WIRING METHOD SHALL BE AS FOLLOWS :
 - FEEDERS AND RISERS - RIGID METALLIC CONDUIT
 - LIGHTING, POWER RECEPTACLE BRANCH CKT., & AUXILIARY - POLYVINYL CHLORIDE CONDUIT
- ALL WIRES SHALL BE COPPER AND THERMOPLASTIC INSULATED TYPE "THW" UNLESS OTHERWISE INDICATED IN THE PLAN. THE MINIMUM SIZE OF WIRE FOR POWER AND LIGHTING CIRCUIT HOMERUN SHALL BE 3.5mm² AND INSULATED FOR 600 VOLTS. SMALLEST RACEWAY SHALL BE 15mm \varnothing TRADE/NOMINAL SIZE.
- ALL OUTLET BOXES SHALL BE GALVANIZED GAUGE NO. 16 DEEP TYPE WITH FACTORY KNOCKOUTS.
- ALL MATERIALS TO BE USED SHALL BE BRAND NEW AND APPROVED TYPE FOR THE PARTICULAR LOCATION AND PURPOSE.
- GROUNDING SYSTEM SHALL BE PROVIDED TO ALL LIGHTING AND POWER CIRCUIT AS PER PHILIPPINE ELECTRICAL CODE REQUIREMENT.
- MOUNTING HEIGHT OF WIRING DEVICES SHALL BE AS FOLLOWS :
 - LIGHT SWITCH - 1.20 M ABOVE FINISH FLOOR
 - CONVENIENCE OUTLET - 0.30 M ABOVE FINISH FLOOR.
 - SAFETY SWITCH - 1.80 M ABOVE FINISH FLOOR

1. TOTAL LOAD:

A. LIGHTING OUTLET	5 x 100 W = 500 W
B. FAN OUTLET	1 x 100 W = 100 W
C. CONVENIENCE OUTLET	2 x 180 W = 360 W
TOTAL LOAD	= 960 W
I LOAD	960 / 230 = 4.17 A

2. CIRCUIT REQUIREMENT:

USE 20 A 2-WIRE CIRCUIT

3. SERVICE ENTRANCE CONDUCTORS:

USE 2-3.5 mm² THW COPPER WIRES

4. SERVICE EQUIPMENT:

USE 1-30 A, 2PST, 250V SAFETY SWITCH WITH 2-20 A, RENEWABLE FUSES

5. SCHEMATIC DIAGRAM OF SAFETY SWITCH:

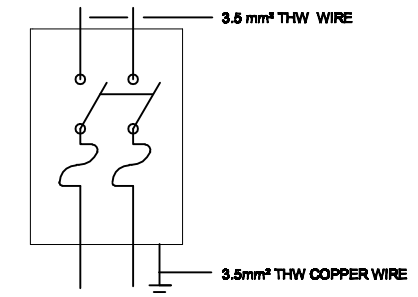

LEGEND

SYMBOL	DESCRIPTION
	- CEILING LIGHT OUTLET
	- 2 x 40 WATTS FLUORESCENT LAMP
	- CEILING FAN OUTLET
	- ONE GANG DEVICE SWITCH
	- TWO GANG DEVICE SWITCH
	- THREE GANG DEVICE SWITCH
	- THREE WAY DEVICE SWITCH
	- FAN CONTROL SWITCH
	- RACEWAY CONDUIT CONCEALED IN CEILING
	- RACEWAY CONDUIT CONCEALED UNDER FLOOR
	- SAFETY SWITCH
	- DUPLEX CONVENIENCE OUTLET, GROUNDING TYPE 10 AMPS, 250 VOLT WITH MODERN PLATE COVER
	- ELECTRIC SERVICE METER
	- SERVICE ENTRANCE

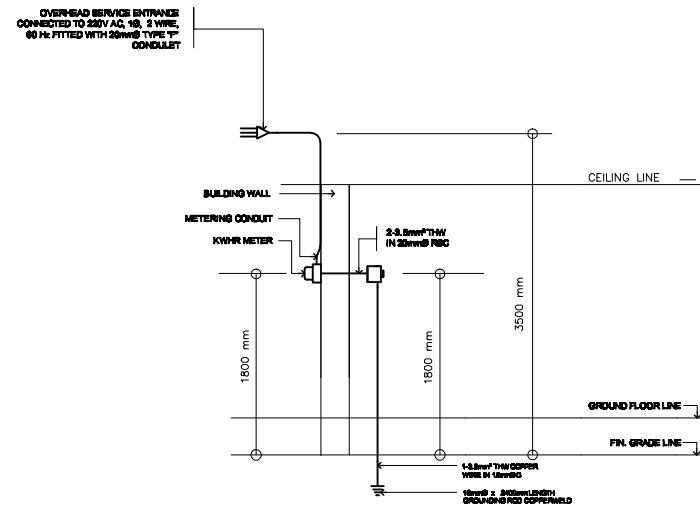

ELECTRICAL RISER DIAGRAM

NOT TO SCALE

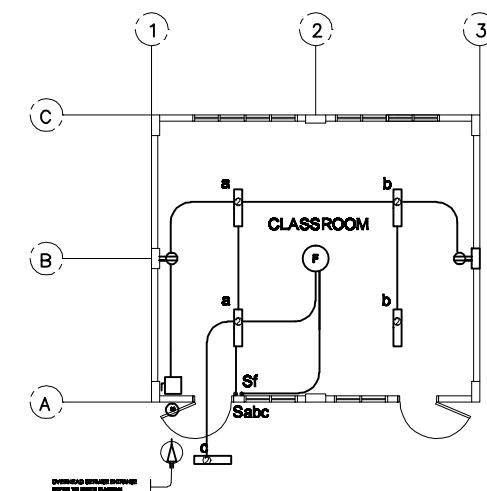

ELECTRICAL LAYOUT

SCALE 1:100 M